



# EDUCATIONAL FACILITIES

SCHOOLS, UNIVERSITIES & COMMUNITY CENTERS

WDG | ARCHITECTS ENGINEERS



WDG | Architects Engineers is a full service architecture, engineering, design and planning firm which focuses on educational, hospitality, industrial and civic/government project types. Our diverse team includes architects and engineers whose vast experience in educational design and planning goes back more than 30 years, spanning numerous states and municipalities. Our unique background and approach allows us to work with each client and efficiently deliver the best combination of architectural and engineering services to suit the particular needs of the campus, facility and budget.

## early childhood, primary, secondary and higher education facilities

WDG has been regularly called upon to provide design and management services for primary and secondary schools, colleges and universities, early childhood learning centers and community centers. Our services vary from client to client and include master planning, facility assessment, programming, code review, architectural design, engineering, project management and construction contract administration. Additionally, our staff has significant experience working with FEMA, Historic Tax Credits, and with projects seeking LEED certification.





# primary & secondary education

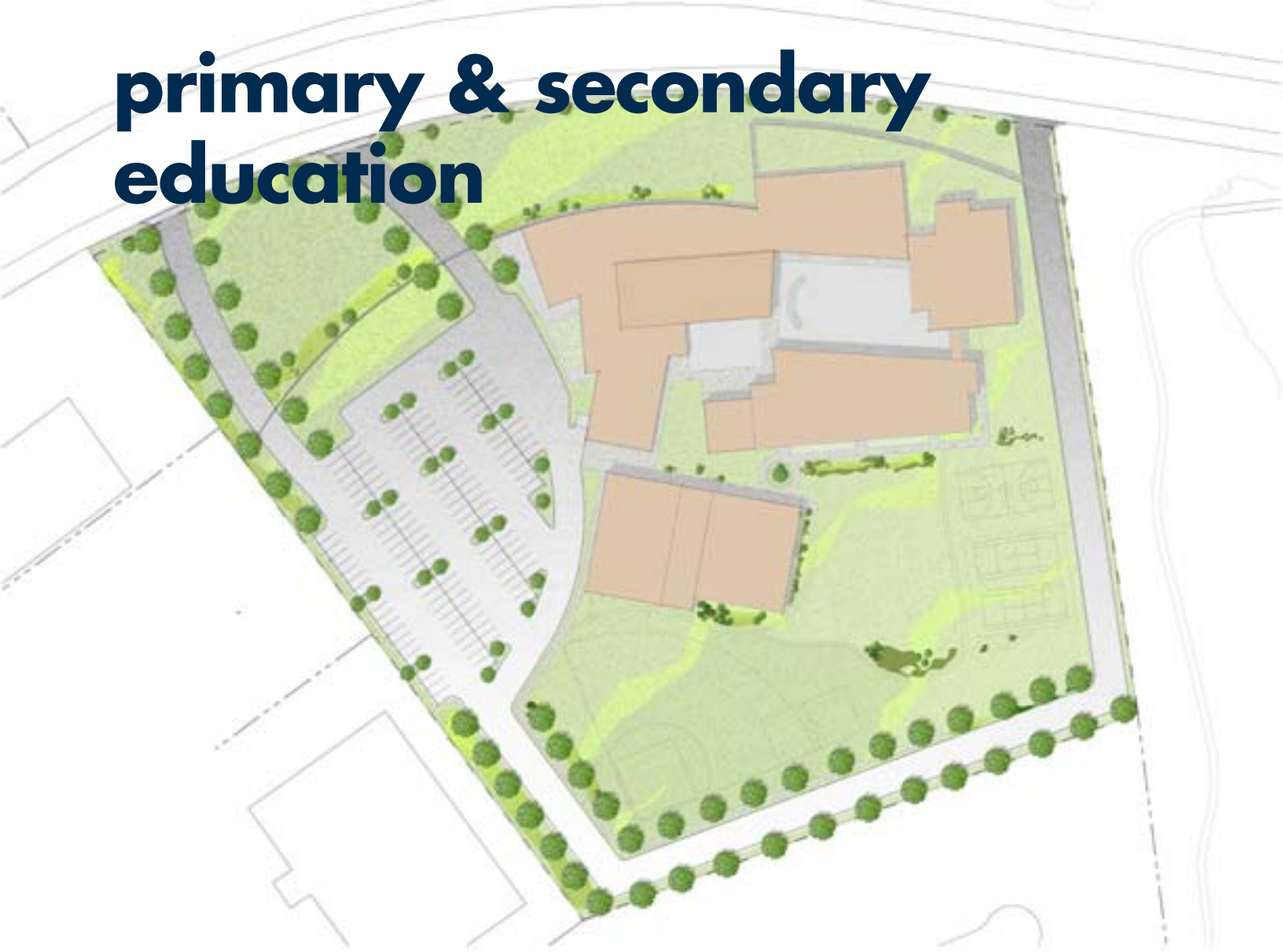

## LAKE FOREST ELEMENTARY SCHOOL

NEW ORLEANS, LA

WDG | Architects Engineers provided planning, architectural, engineering and interior design services to Lake Forest Elementary Charter School in an effort to develop a new campus in New Orleans East. The campus includes classrooms, library and media center, kitchen and cafeteria, gymnasium, outdoor recreation areas, administrative offices and ancillary support facilities for a projected 500 students ranging from Pre-K to 8th grade.

## ALICE M. HARTE ELEMENTARY SCHOOL

NEW ORLEANS, LA

WDG was selected by the Recovery School District in association with Orleans Parish School Board to provide comprehensive architecture and engineering design and construction contract administration services for the replacement charter school.

The existing school was damaged during Hurricane Katrina. The new 111,800 square foot school is designed for 600 students from Pre-K to 8th Grade. The program consisted of a three-story classroom building, gymnasium, cafeteria, black box theater, library, and administration areas. The school was designed and constructed to meet LEED Silver certification.





**ST. ANDREW’S EPISCOPAL SCHOOL MASTER PLAN**

NEW ORLEANS, LA

WDG provided planning, architectural and engineering services for St. Andrew’s Episcopal School. The scope of work consisted of an assessment of the overall needs of the campus, its individual buildings and outdoor spaces. In addition, WDG developed a Master Plan for the existing and future facilities as the school seeks to accommodate its current student body, faculty and staff; while preparing for a substantially increased enrollment. The campus upgrades include re-configuration of classrooms, administration offices and outdoor recreation areas for a projected 250 students ranging from Pre-K to 8th grade.

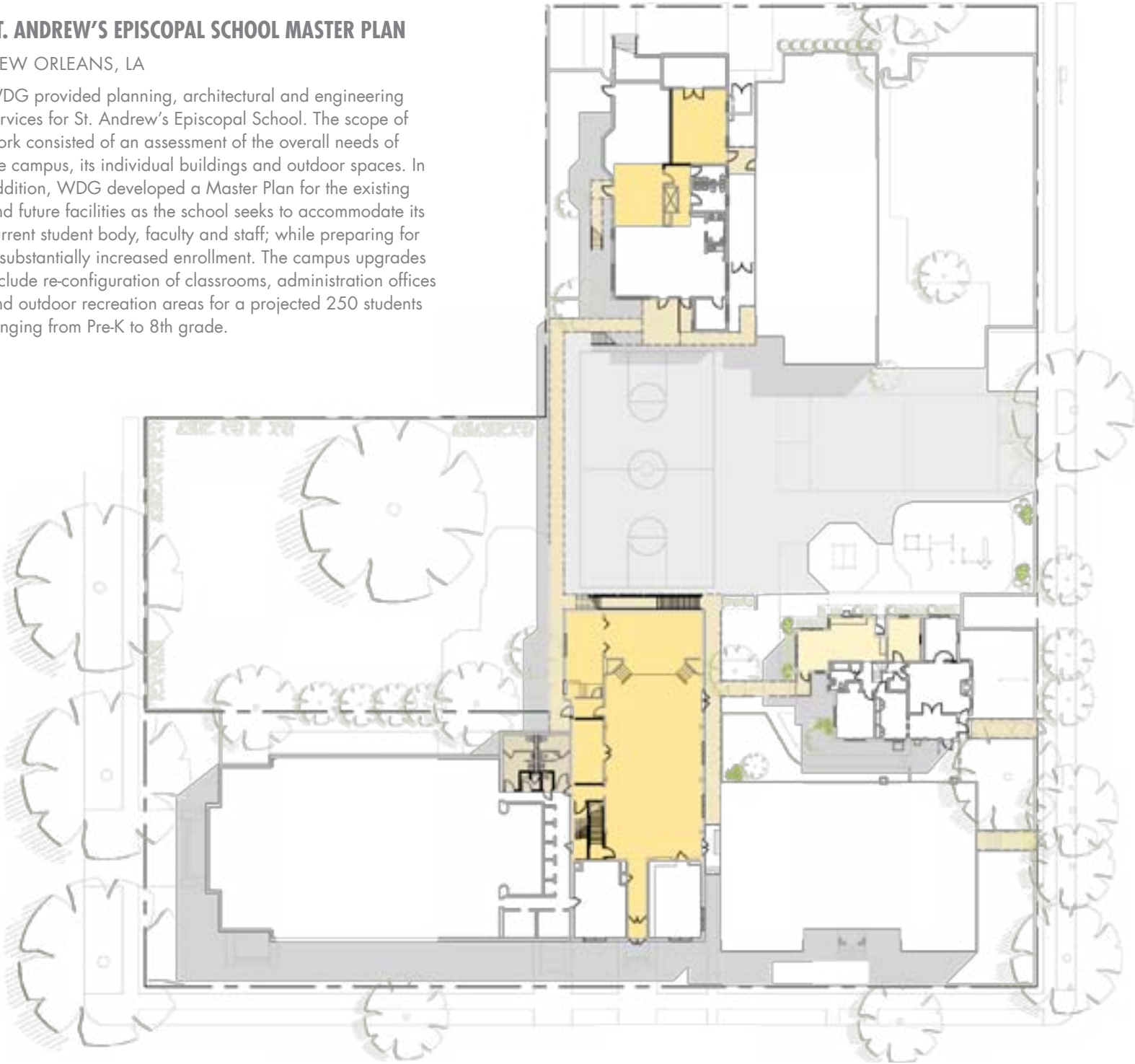

**LEE ROAD JUNIOR HIGH SCHOOL**

COVINGTON, LA

WDG provided architectural, mechanical, electrical, and plumbing engineering services for the St. Tammany Parish School Board. The design included ten new classrooms, teacher workrooms and a connection to the existing building. The expansion also included a new packaged sewer treatment system.



**MADISONVILLE JUNIOR HIGH SCHOOL**

MADISONVILLE, LA

WDG provided architectural and engineering design services for the renovation of the Madisonville Junior High School Music Building. The project consisted of the removal and replacement of roofing as well as waterproofing and tuckpointing approximately 25 percent of the exterior brick.



**BOOTHVILLE-VENICE ELEMENTARY SCHOOL**

BOOTHVILLE, LA

WDG provided architectural and engineering design services for the redesign of a failed roof due to wind damage at Boothville-Venice Elementary School. WDG designed an entire roofing system with a 30-year warranty and provided additional problem-solving assessments to assist the School Board with corrections to failing mechanical and electrical systems.



**FIRSTLINE CHARTER SCHOOLS**

NEW ORLEANS, LA

WDG provided mechanical system assessments and recommissioning services for FirstLine Charter Schools. The scope included an energy audit and an energy conservation measure analysis. First Line Charter School operates five schools throughout the New Orleans Metropolitan area.





**BELLE CHASSE MIDDLE SCHOOL**

BELLE CHASSE, LA

WDG provided architecture and engineering design services for a new concessions and restroom building at Belle Chasse Middle School. Design components include a concession/kitchen prep area, locker room facilities, deck/patio viewing area and restrooms. The building’s curvilinear form centers around a live oak tree in the middle of the site and embraces views of the adjacent ball field. The façade is a series of ipê hardwood slats, which allow the building to breathe and ventilate naturally in addition to blending into the lush, forested environs that surround the campus.



**BELLE CHASSE HIGH SCHOOL**

BELLE CHASSE, LA

WDG provided planning, architecture and engineering services for the design of several new athletic buildings and a relocated baseball field on the high school’s campus. Facilities include a new field house, press box, concessions area, locker rooms, bleacher stands, dugouts and restroom areas for the women’s softball team and the high school football team.



# early childhood & community centers

## MAHALIA JACKSON EARLY CHILDHOOD LEARNING AND COMMUNITY CENTER

NEW ORLEANS, LA

WDG provided mechanical, electrical, plumbing and fire protection engineering for the complete renovation of a 50,000 square foot elementary school, converting it into the Mahalia Jackson Early Childhood Learning and Community Center. A portion of the facility was reconfigured for children from infancy through five years old. The remaining area was remodeled as a neighborhood center, which serves as a community education center for adults and children, a location for sports and activities and a library. This project was FEMA funded.



## EDISEN HOUSE EARLY CHILDHOOD LEARNING CENTER

METAIRIE, LA

WDG provided planning and architecture design services for Metairie Park Country Day School to expand and renovate Edisen House Early Childcare Facility. At the onset of the project, WDG met with school representatives to gain an in-depth understanding of the physical and spatial requirements as dictated by licensing and facility needs.



## URSULINE ACADEMY EARLY LEARNING CENTER

NEW ORLEANS, LA

WDG provided mechanical, electrical, plumbing and fire protection engineering for the restoration and floodproofing of the Early Learning Center for Ursuline Academy, the oldest continuously operating Catholic school in the United States. The Early Learning Center is located inside a renovated historic building, which was flooded after Hurricane Katrina. This project was FEMA funded.



## MAIN LIBRARY RENOVATIONS

NEW ORLEANS, LA

Due to a combination of Hurricane Katrina damage and deferred maintenance over fifty years, the City of New Orleans Main Library building required various repairs. WDG surveyed existing conditions and provided a scoping document with budget estimates. WDG also provided full construction documents for mechanical improvements of ten air handler units, replacement of the electrical switchgear, elevator upgrades, improved security, as well as interior and exterior renovations of the library to remove barriers and improve ADA accessibility.



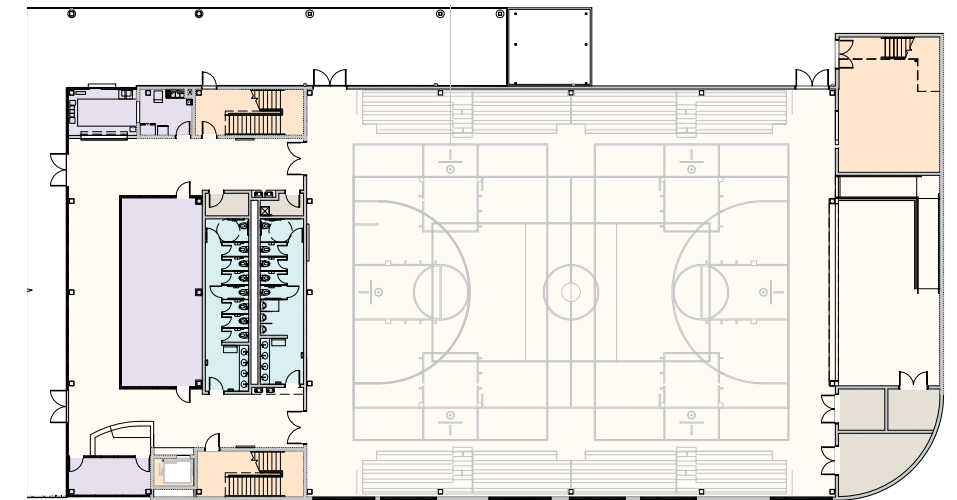

## ROSENWALD CENTER - MULTI-USE COMMUNITY CENTER

NEW ORLEANS, LA

WDG was selected to assess damages and provide a Comprehensive Damage Report for the City of New Orleans and FEMA after the building was severely damaged due to Hurricane Katrina. WDG provided architecture and engineering services in the design of the new facility, and the coordination of the repairs to the existing pool.

The new facility incorporates indoor basketball courts, weight rooms, classrooms to teach dance, music, pottery, arts, sewing, snack bar areas and public meeting rooms. Outdoor facilities include a baseball field, children's play area and a walking track. The complex is designed to exceed the current code requirements for disaster durability so that it may be utilized as a storm shelter in the event of a hurricane.

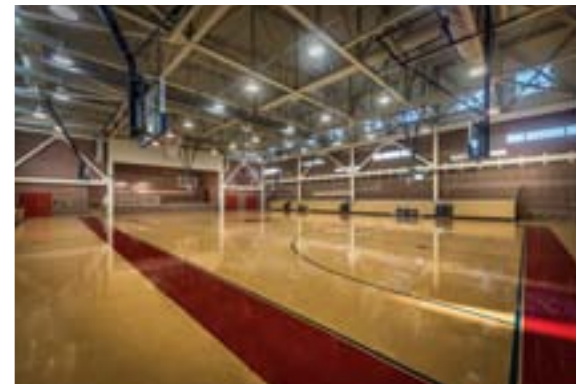



# colleges & universities

## LOUISIANA STATE UNIVERSITY HEALTH SCIENCES CENTER

NEW ORLEANS, LA

WDG provided mechanical, electrical, plumbing, and fire protection engineering services for the assessment of Hurricane Katrina related damages on the LSUHSC campus. This work included the following buildings: Resource Center, Medical Education Building, Residence Hall, Clinical Sciences Building, Lion’s Eye, Allied Health and Nursing Building, Medical School, Central Plant, S. Roman Parking Garage, Auxiliary Enterprise Warehouse, Vivarium, Human Development-Allied Health and the Human Development Library.

WDG provided restoration and mitigation design for 7 of these buildings, which were FEMA-funded.

## SOUTHERN UNIVERSITY

BATON ROUGE, LA

WDG | Architects Engineers provided architectural services for the renovation of three buildings at Southern University in Baton Rouge, LA. Buildings include the Agriculture Farm Building, Livestock Arena, and Hayden Hall.

## DELGADO COMMUNITY COLLEGE LIBRARY

NEW ORLEANS, LA

WDG provided the mechanical and electrical systems design for the restoration and mitigation of the Library Building at Delgado Community College in New Orleans.

## TULANE UNIVERSITY CENTRAL PLANT

NEW ORLEANS, LA

WDG provided architecture, mechanical and electrical engineering for the replacement and renovation of the electrical switchgear in the central plant damaged in Hurricane Katrina. This resulted in increased capacity of the chilled water plant and improved services for the entire campus-wide chilled water distribution system (by means of engineering techniques and automated controls). Included in this work was the demolition of the Logistics Building and construction of an addition to the Power Plant to match the existing building design, resulting in a seamless edifice. The new addition accommodates a 4500 ton chiller, pumps, cooling towers, control system, 480V and 4160V electrical switchgear and space for logistical support.

## XAVIER UNIVERSITY OF LOUISIANA

NEW ORLEANS, LA

WDG Engineers was hired by Siemens Building Technologies, Inc. to coordinate the implementation of a demand flow chilled water pumping system test at Xavier University. As a result, the analysis of flow diagrams was conducted to determine the required modifications for variable flow system implementation, as well as performing pressure loss calculations associated with required piping modifications and to develop schematic drawings of the central plant chilled water system.

# clients

## PRIMARY & SECONDARY

Algiers Charter Schools Association  
Firstline Charter Schools  
Orleans Parish School Board  
Plaquemines Parish School Board  
Roman Catholic Archdiocese of New Orleans  
St. Andrew’s Episcopal School  
St. Tammany Parish School Board  
Jefferson Parish School Board

## COLLEGES & UNIVERSITIES

Delgado Community College  
Louisiana State University Health and Sciences Center  
Southern University, Baton Rouge  
Tulane University  
Xavier University of Louisiana

## EARLY CHILDHOOD & COMMUNITY CENTERS

City of New Orleans  
Orleans Parish School Board  
Roman Catholic Archdiocese of New Orleans  
Trinity Episcopal Church  
Metairie Park Country Day School

# services

## ARCHITECTURE

Master Planning  
Site Planning  
New Construction  
Schematic Programing  
Code Review  
Building Renovations  
Interior Design  
Space Planning  
Furniture Selection  
Facade Restoration  
Building Restoration  
Adaptive Reuse  
Feasibility Studies

## ENGINEERING

Chilled Water Systems  
Steam Systems  
Environmental Control Systems  
Water Treatment Systems  
Wastewater Treatment Systems  
Standby Generator Systems  
Lighting Systems  
Structural & Civil Engineering Coordination  
MEP Engineering Coordination

## OTHER

Project Management  
Construction Contract Administration  
LEED Certification  
Building Commissioning  
Building Performance Analysis  
Damage Assessments  
Green Building Certification

# damage assessments

## ORLEANS PARISH SCHOOL BOARD SCHOOL ASSESSMENTS AND ASSOCIATED HURRICANE KATRINA REPAIRS

WDG was selected by the Orleans Parish School Board for design and construction management services for eleven Hurricane Katrina damaged schools. WDG’s responsibilities included the establishment of scope, facility and roof inspections, reviewing and analyzing FEMA paperwork, design and placement of temporary facilities and design of repairs. The schools included were: Warren Easton High School, Ben Franklin High School, Lusher Elementary School, Hansberry School, St. Simon Peter, Bethune, Priestly, Our Lady of Lourdes, Eleanor McMain, Alice M. Harte, and Philis Wheatley. WDG had direct contact with FEMA representatives during these projects and coordinated with FEMA on all temporary facilities.







WDG | ARCHITECTS ENGINEERS

821 BARONNE ST  
NEW ORLEANS, LA 70113  
(504) 754-5280  
[www.wdgnola.com](http://www.wdgnola.com)

WDG is certified by the City of New Orleans  
as a State and Local Disadvantaged Business  
Enterprise (DBE) and by the State of Louisiana as  
a Small Entrepreneurship (Hudson/SE) vendor.

For further information about WDG's work, please visit [www.wdgnola.com](http://www.wdgnola.com)  
or check us out on social media

